

# Solenoid valve(3/2 way)

## 3V2M Series



### Ordering code

#### Ordering code for valve

**3V2M NC A □**

① ② ③ ④

#### ① Model

3V2M: Solenoid valve  
(3/2 way, with manifold)

#### ② Acting type

NC: Normally closed  
NO: Normally opened

#### ③ Standard voltage

A: AC220V  
B: DC24V  
C: AC110V  
E: AC24V  
F: DC12V

#### ④ Electrical entry

Blank: Terminal  
I: Flying leads

[Note]: The wire length is 5m.

#### Ordering code for manifold

**3V2M 5F D T**

① ② ③ ④

#### ① Model

3V2M: Solenoid valve  
(3/2 way, with manifold)

#### ② Number of stations

1F: 1 Stations  
2F: 2 Stations  
.....  
20F: 20 Stations

#### ③ Exhaust type

Blank: Centralized exhaust  
D: Separated exhaust

#### ④ Thread type

T: NPT

[Note]: Manifold kits contains manifold, seal and screw.  
The port size is only 1/8".

#### Ordering code for valve's group (valve+manifold)

**3V2M NC A □ - 5F D T**

① ② ③ ④ ⑤ ⑥ ⑦

#### ① Model

3V2M: Solenoid valve  
(3/2 way, with manifold)

#### ② Acting type

NC: Normally closed  
NO: Normally opened

#### ③ Standard voltage

A: AC220V  
B: DC24V  
C: AC110V  
E: AC24V  
F: DC12V

#### ④ Electrical entry

Blank: Terminal  
I: Flying leads

#### ⑤ Number of stations

1F: 1 Stations  
2F: 2 Stations  
.....  
20F: 20 Stations

#### ⑥ Exhaust type

Blank: Centralized exhaust  
D: Separated exhaust

[Note]: The wire length is 5m.

#### ⑦ Thread type

T: NPT

#### Ordering code for blank plate

**P-3V2M-R2**

① ② ③

#### ① Subassembly type

P: subassembly

#### ② Valve type

3V2M: Solenoid valve(3/2 way, with manifold)

#### ③ Accessories type

R2: Blank plate for manifold

[Note]: Blank plate kits contains blank plate and screw.

## 3V2M Series

### Specification

Model	3V2M
Fluid	Air(to be filtered by 40μm filter element)
Acting	Direct acting
Port size [Note1]	1/8"
Valve type	3 port 2 position
Orifice size	1.7mm <sup>2</sup> (Cv=0.1)
Exhaust type	Centralized exhaust\Separated exhaust
Operating pressure	0~114psi(0~0.8MPa)
Proof pressure	175psi(1.2MPa)
Temperature	-20~70°C
Material of body	Aluminum alloy

[Note1] NPT thread is available.

### Coil specification

Item	specification
Standard voltage	AC220V, AC110V, AC24V, DC24V, DC12V
Scope of voltage	AC: ±15% DC: ±10%
Power consumption	AC: 7VA DC: 7.0W
Protection	IP65(DIN40050)
Temperature classification	B Class
Electrical entry	Terminal, Flying leads
Activating time	0.05 sec and below
Max. frequency [Note1]	10 cycle/sec

[Note1] The maximum actuation frequency is in the no-load state.

### Inner structure

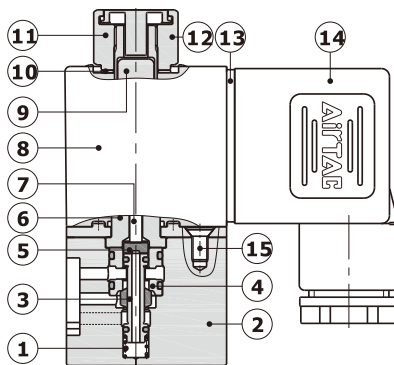

No.	Item	No.	Item
1	Spring	9	Armature
2	Body	10	Washer
3	Spool	11	Coil nut
4	Spacer	12	Manual button
5	Washer	13	Gasket
6	Electromagnet set	14	Connector
7	Man drill	15	Pilot screw
8	Coil		

### Product feature

1. Direct acting type and normally closed mode, flexible in direction change.
2. Normally closed and normally open types are optional.
3. Structure in coaxial blanking mode: leakage proof and large air flow.
4. No need to add oil for lubrication.
5. Affiliated manual devices are equipped to facilitate installation and debugging.
6. Valve needs to be used with the sub-base and allows various connection combinations to save space.
7. It is easy to examine when there are faults owing to the unified air intake and exhaust and unified wiring.
8. Flexible combination and strong expansion capability can make any combination or expansion of the numbers of direction control valves that are connected.
9. Can adjust the installation direction of special sub-base seal for NO or NC functions.

### Flow chart

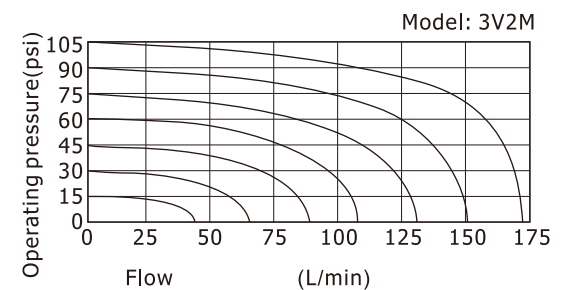

# Solenoid valve(3/2 way)

## 3V2M Series

### Dimensions

#### Valve(Terminal)

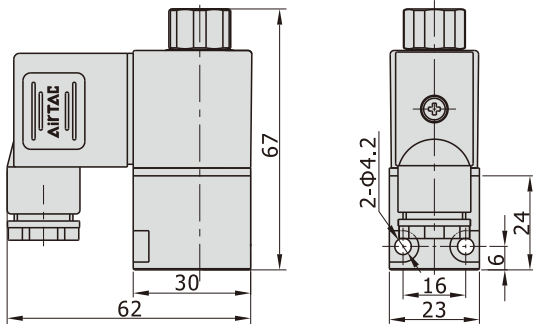

#### Valve(Flying leads)

[Unit: mm]

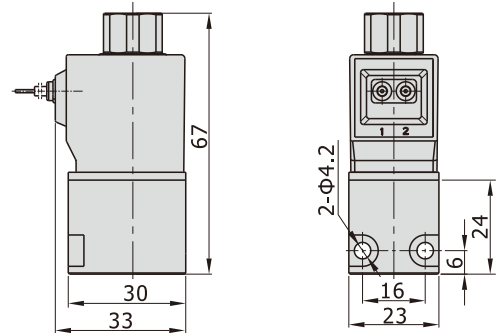

#### Valve's group(Terminal, Centralized exhaust)

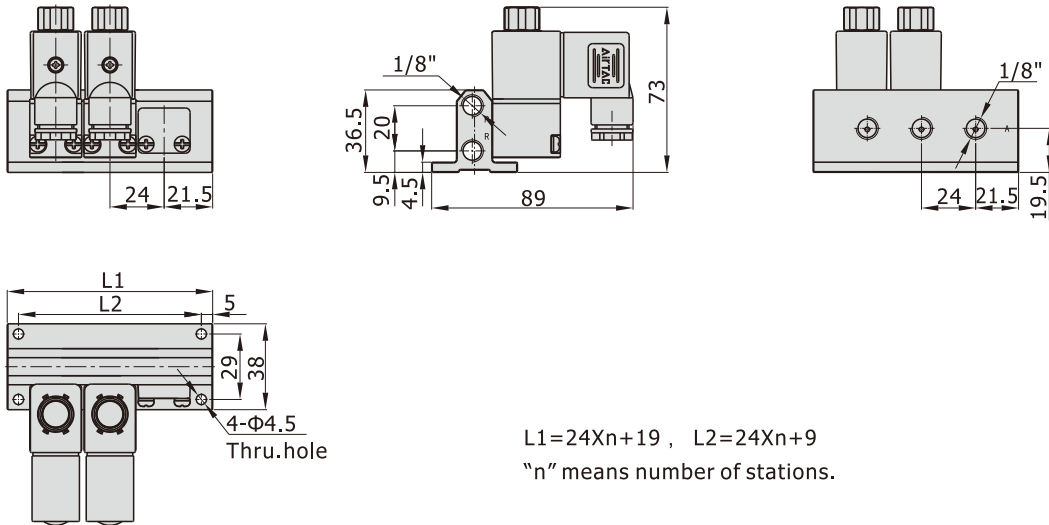

#### Valve's group(Flying leads, Centralized exhaust)

